

OFFICIAL ZONING MAP

TULPEHOCKEN TOWNSHIP

BERKS COUNTY, PENNSYLVANIA

- ENVIRONMENTAL PROTECTION
- VILLAGE CENTER
- RURAL RESIDENTIAL
- INDUSTRIAL AND COMMERCIAL
- EFFECTIVE AGRICULTURAL PRESERVATION

0' 1500' 3000' 4500'

1"=1500'

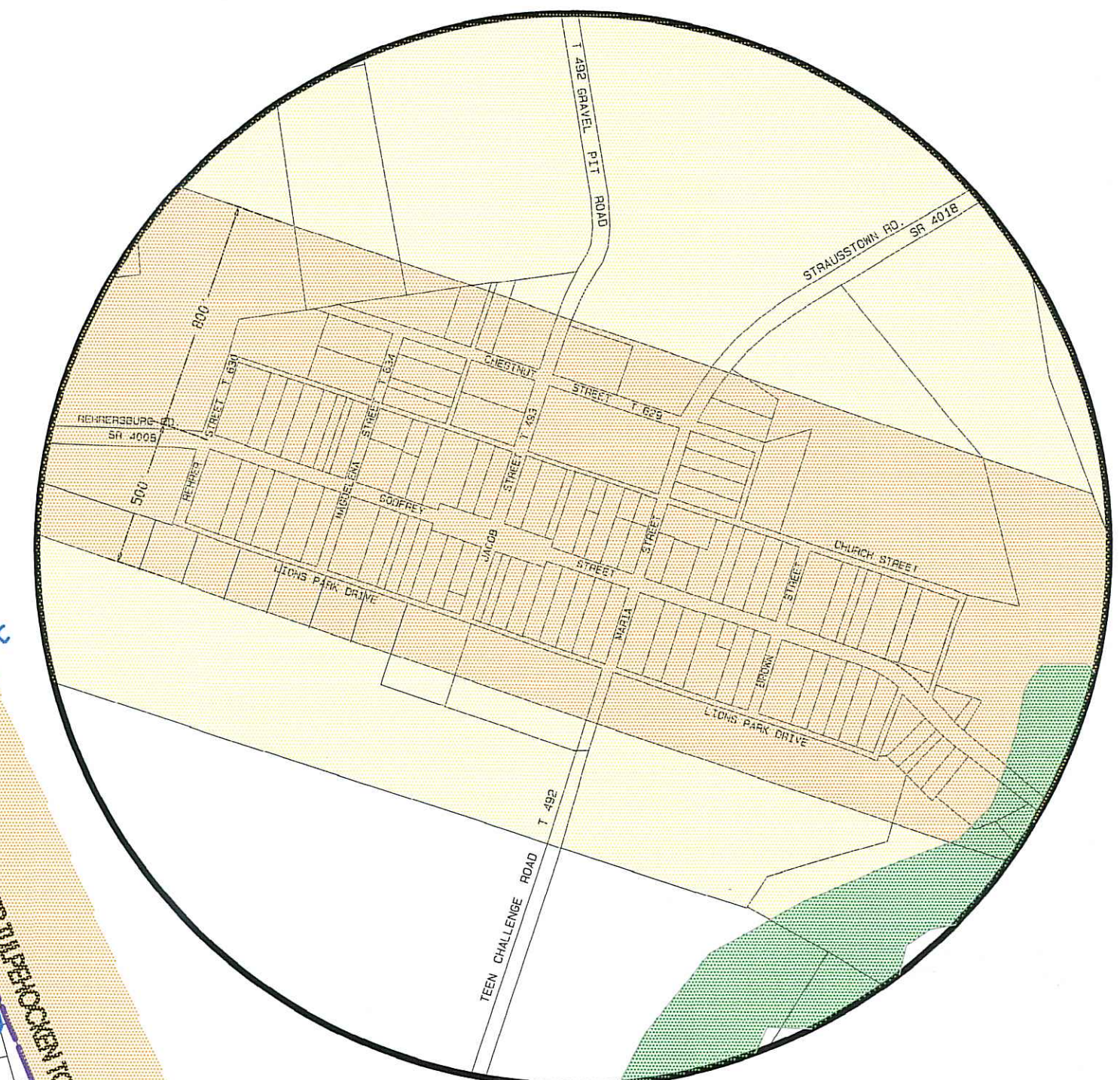
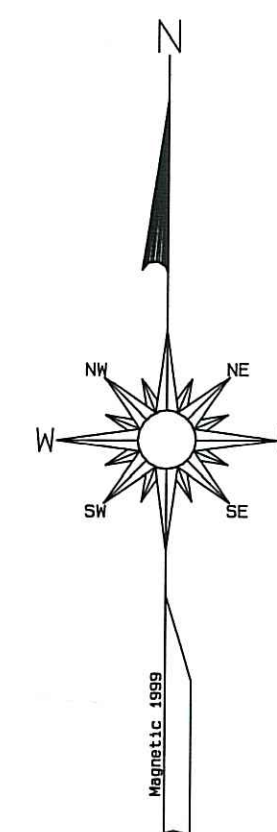

REHERSBURG

0' 500' 1000' 1500'

1"=500'

THIS IS TO CERTIFY THAT THIS IS THE OFFICIAL ZONING MAP OF THE TOWNSHIP OF TULPEHOCKEN, ADOPTED ON MARCH 8, 2017, WHICH SUPERSEDES ALL PRIOR ZONING MAPS OF THE TOWNSHIP, MOST RECENT AMENDMENT:

ATTEST:

Christy Flaherty
SECRETARY OF THE BOARD OF SUPERVISORS

Richard A. Kram
VICE CHAIRMAN OF THE BOARD OF SUPERVISORS

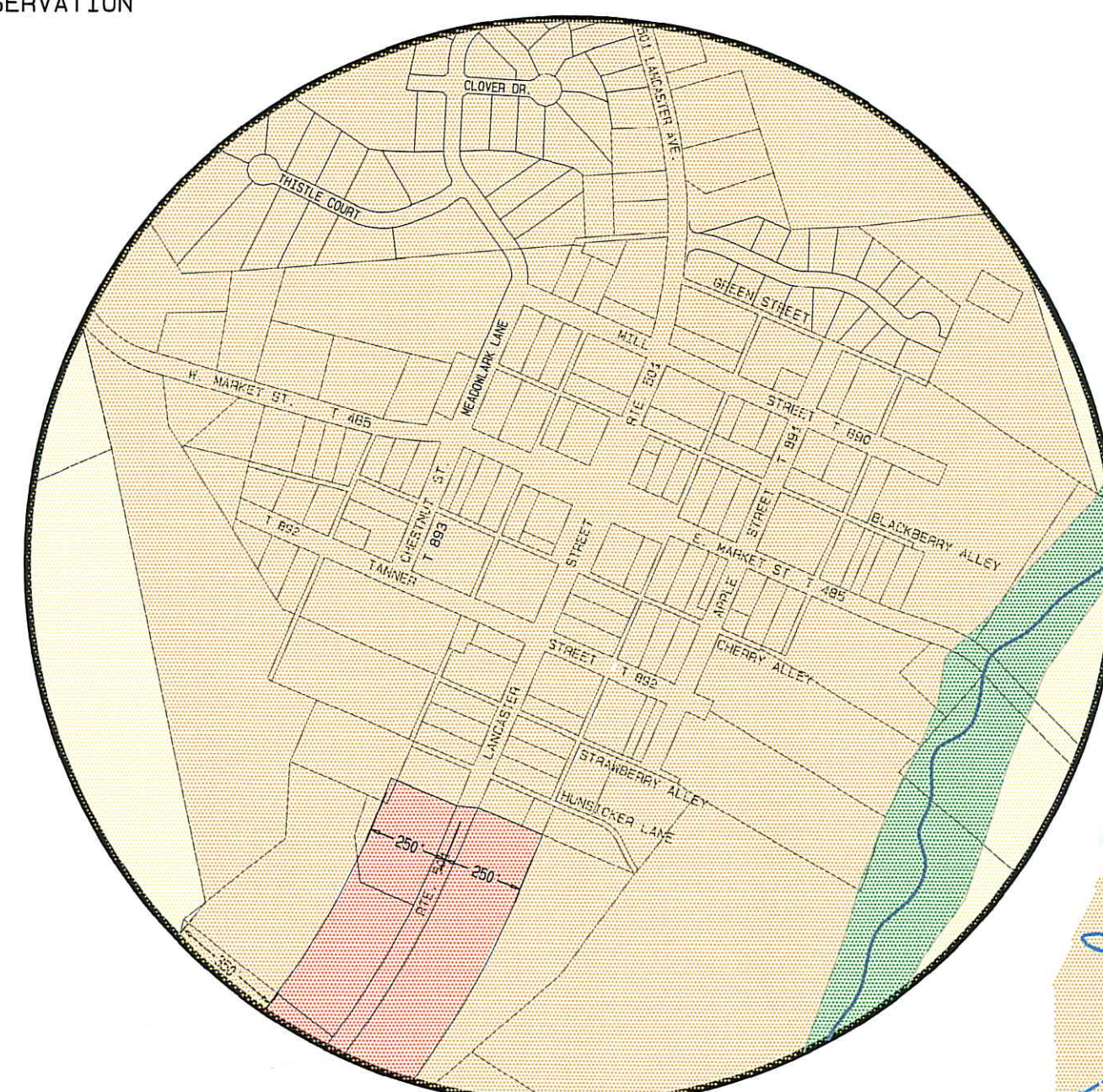

MT. AETNA

0' 500' 1000' 1500'

1"=500'

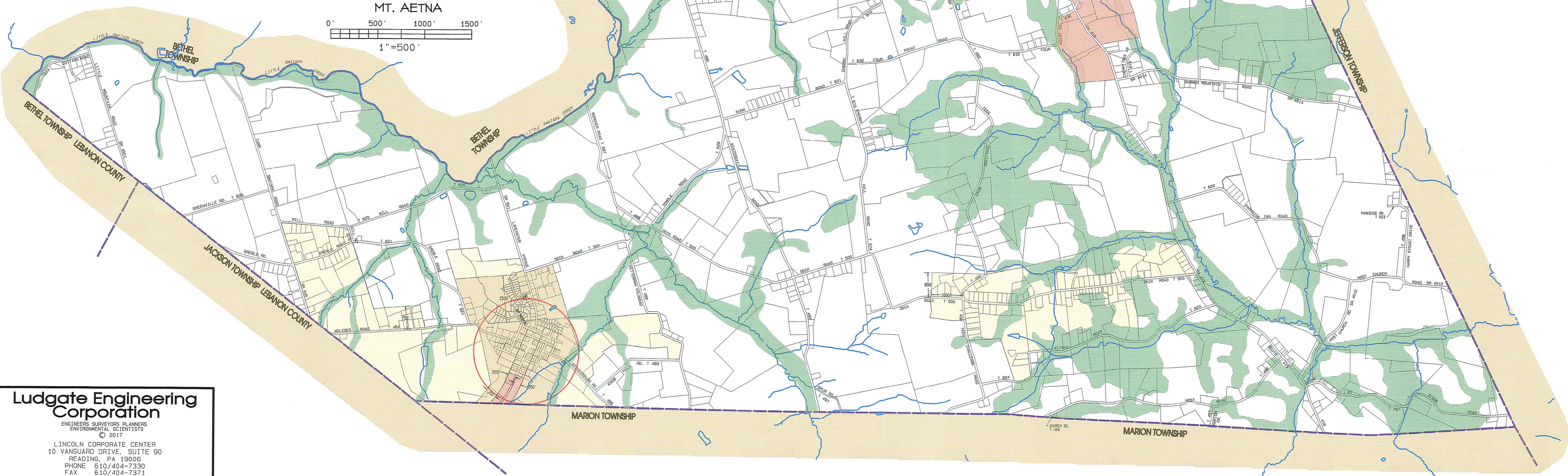

Ludgate Engineering Corporation
ENGINEERS SURVEYORS PLANNERS
ENVIRONMENTAL SCIENTISTS
© 2017
LINCOLN CORPORATE CENTER
10 VANGUARD DRIVE, SUITE 90
READING, PA 19606
PHONE 610/404-7330
FAX 610/404-7371